

# Connector block CPE10-PRSEO-2

Part number: 187828

Classic - do not use for new projects

FESTO

For Compact Performance valves with open PRS ducts.

Only fittings with a G connection may be used with this manifold.

Modern alternatives can be found by entering the first four characters of the type code in the search field.

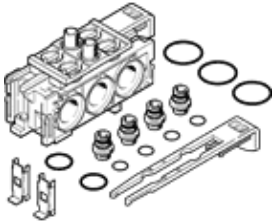

## Data sheet

Feature	Value
Max. number of valve positions	2
Operating medium	Compressed air in accordance with ISO8573-1:2010 [7:4:4]
Note on operating and pilot medium	Lubricated operation possible (subsequently required for further operation)
Corrosion resistance classification CRC	2 - Moderate corrosion stress
Product weight	40 g
Mounting method for subbase	with through hole with top-hat rail
Pneumatic connection, port 1	G1/4
Materials note	Free of copper and PTFE Conforms to RoHS
Material housing	PA-reinforced