

# Guide unit SPZ-16-25-P-A-KF

Part number: 162172  
Product to be discontinued

FESTO

With 2 piston rods (Twin slide), for proximity sensing.  
Type to be discontinued. Available until 2019. See Support Portal for alternative products.

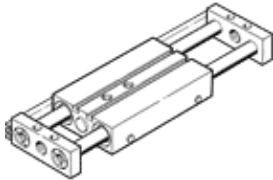

## Data sheet

Feature	Value
Stroke	25 mm
Adjustable end-position range/length	10 mm
Piston diameter	16 mm
Operating mode of drive unit	Slide
Cushioning	Pneumatic cushioning with fixed metallic stop
Assembly position	Any
Guide	Recirculating ball bearing guide
Design structure	Guide
Position detection	For proximity sensor
Working pressure	1 ... 10 bar
Mode of operation	double-acting
Operating medium	Compressed air in accordance with ISO8573-1:2010 [7:4:4]
Note on operating and pilot medium	Lubricated operation possible (subsequently required for further operation)
Corrosion resistance classification CRC	0 - No corrosion stress
Ambient temperature	-20 ... 80 °C
Theoretical force at 6 bar, return stroke	180 N
Theoretical force at 6 bar, advance stroke	180 N
Pneumatic connection	M5
Material cover	Wrought Aluminum alloy
Material seals	NBR
Material housing	Wrought Aluminum alloy
Material piston rod	Case-hardened steel