

semi-rotary drive DAPS-0015-090-R-F03-T6

Part number: 553170

FESTO

double-acting, air connection to VDI/VDE 3845 Namur valves, direct flange mounting, version with handwheel, low temperature version.

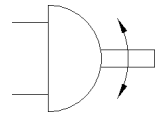
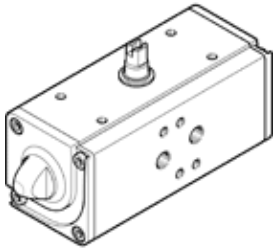

Data sheet

Feature	Value
Size of actuator	0015
Flange hole pattern	F03
Swivel angle	90 deg
End-position adjustment range at 0°	-1 ... 9 deg
Shaft connection depth	13.2 mm
Fitting connection conforms to standard	ISO 5211
Cushioning	No cushioning
Assembly position	Any
Mode of operation	double-acting
Design structure	Yoke kinematics
Position detection	No
Closing direction	right-closing
Valve connection conforms to standard	VDI/VDE 3845 (NAMUR)
Safety Integrity Level (SIL)	Product can be used in SRP/CS up to SIL 2 low demand
Operating pressure MPa	0.3 ... 0.84 MPa
Operating pressure	3 ... 8.4 bar
Nominal operating pressure	0.56 MPa 5.6 bar
Max. swivel frequency at 0.6 MPa (6 bar, 87 psi)	1 Hz
CE mark (see declaration of conformity)	to EU directive explosion protection (ATEX)
UKCA marking (see declaration of conformity)	To UK EX instructions
Certificate issuing department	TÜV Nord 212170801
ATEX category Gas	II 2G
ATEX category Dust	II 2D
Explosion ignition protection type Gas	Ex h IIC T6...T3 Gb X
Explosion ignition protection type Dust	Ex h IIIC T85°C...T200°C Db X
Explosion-proof ambient temperature	-50°C ≤ Ta ≤ +60°C
Operating medium	Compressed air in accordance with ISO8573-1:2010 [7:4:4]
Note on operating and pilot medium	Lubricated operation possible (subsequently required for further operation)
Corrosion resistance classification CRC	3 - High corrosion stress
PWIS conformity	VDMA24364 zone III
Ambient temperature	-50 ... 60 °C
Torque at rated operating pressure and 0° rotation angle	15 Nm
Torque at nominal operating pressure with 50° swivel angle	7.5 Nm
Torque at nominal operating pressure with 90° swivel angle	11.3 Nm
Note about the torque	The operating torque of the actuator must not be higher than the maximum permissible torque listed in ISO 5211, with reference to the size of the mounting flange and of the coupling.
Air consumption at 0.6 MPa (6 bar, 87 psi) per cycle 0°-nominal swivel angle-0°	0.56 l
Product weight	750 g
Shaft connection	T11
Pneumatic connection	G1/8

Feature	Value
Materials note	Conforms to RoHS
Material cover	Wrought Aluminium alloy
Material seals	FVMQ PTFE reinforced
Material housing	Wrought Aluminium alloy
Material screws	High alloy steel
Material shaft	High alloy steel
Material number for shaft	1.4305