

gear unit EMGA-40-P-G5-SAS-40

Part number: 552187

FESTO

Suitable for servo motors.

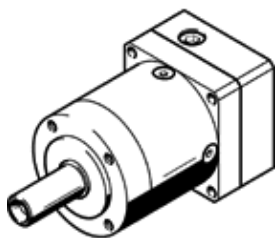

Data sheet

Feature	Value
Gear unit flange size	40 mm
Motor flange size	40 mm
Torsional backlash	0.25 deg
Type of gear unit	Planetary gear unit
Gear unit ratio	5:1
Max. input speed	18,000 1/min
Operating temperature of gear unit	-25 ... 90 °C
Protection class	IP54
Continuous output torque	14 Nm
Mass moment of inertia of gear unit	0.019 kgcm ²
Max. output torque	22 Nm
Max. efficiency	98 %
Torsional resistance	1 Nm/arcmin
Product weight	350 g
Gear unit interface, output shaft	40G
Gear unit interface, drive shaft	40A
Materials note	Conforms to RoHS