

# Stepper motor MTRE-ST-42-48S-AA

Part number: 530059

FESTO

With integrated controller.

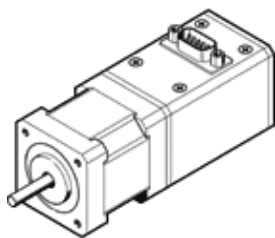

## Data sheet

Feature	Value
Stepper angle at full step	1.8 deg
Stepper angle tolerance	±5%
Operating voltage range DC	24 ... 48 V
Insulation protection class	B
Nominal voltage DC	48 V
Nominal motor current	1.2 A
CE mark (see declaration of conformity)	to EU directive for EMC
Storage temperature	-25 ... 60 °C
Relative air humidity	45 - 80 %
Protection class	IP54
Ambient temperature	0 ... 50 °C
Authorisation	C-Tick
Overall mass moment of inertia at power take-off	0.068 kgcm <sup>2</sup>
Motor holding torque	0.34 Nm
Mass moment of inertia of rotor	0.068 kgcm <sup>2</sup>
Permissible axial shaft load	7 N
Permissible radial shaft load	18 N
Product weight	450 g
Electrical connector system	Plug