

servo motor EMMB-AS-60-04-K-SB

Part number: 5219182

FESTO

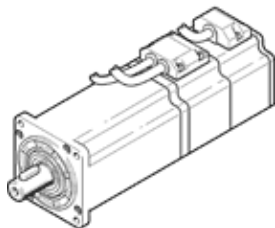

Data sheet

Feature	Value
Ambient temperature	-20 ... 40 °C
Storage temperature	-20 ... 70 °C
Relative air humidity	0 - 90 %
Conforms to standard	IEC 60034
Insulation protection class	F
Rating class according to EN 60034-1	S1
Protection class	IP65
Shaft design Woodruff key	DIN 6885 A 5 x 5 x 16
Electrical connector system	Plug
Materials note	Contains PWIS substances Conforms to RoHS
Corrosion resistance classification CRC	0 - No corrosion stress
CE mark (see declaration of conformity)	to EU directive for EMC to EU directive low-voltage devices
Authorisation	c UL us - Recognized (OL)
Nominal operating voltage DC	300 V
Nominal voltage DC	300 V
Standstill torque	1.4 Nm
Nominal torque	1.27 Nm
Peak torque	3.81 Nm
Nominal rotary speed	3,000 1/min
Max. speed	6,000 1/min
Nominal motor power	400 W
Continuous open-circuit current	2.6 A
Nominal motor current	2.4 A
Peak current	7.2 A
Motor constant	0.562 Nm/A
Voltage constant, phase-to-phase	34 mVmin
Phase-phase winding resistance	5.8 Ohm
Phase-phase winding inductance	11.5 mH
Overall mass moment of inertia at power take-off	0.409 kgcm ²
Product weight	2,100 g
Permissible axial shaft load	90 N
Permissible radial shaft load	180 N
Rotor position sensor	Absolute single turn encoder
Rotary position encoder interface	Nikon A format
Rotary position encoder measuring principle	Optical
Rotary position encoder, typical resolution	20 Bit
Rotary position encoder, typical angular accuracy	20 arcmin
Brake holding torque	1.3 Nm
Operating voltage DC for brake	24 V
Power consumption, brake	7.2 W
Mass moment of inertia of brake	0.004 kgcm ²