

servo motor EMME-AS-80-M-LS-AMB

Part number: 2093171
Product to be discontinued

Without gear unit/with brake.

FESTO

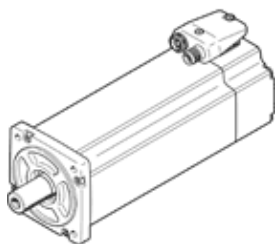

Data sheet

| Feature | Value |
|--|--|
| Ambient temperature | -10 ... 40 °C |
| Storage temperature | -20 ... 70 °C |
| Relative air humidity | 0 - 90 % |
| Conforms to standard | IEC 60034 |
| Insulation protection class | F |
| Rating class according to EN 60034-1 | S1 |
| Protection class | IP21 |
| Electrical connector system | Plug |
| Materials note | Conforms to RoHS |
| Corrosion resistance classification CRC | 0 - No corrosion stress |
| PWIS conformity | VDMA24364 zone III |
| Authorisation | RCM Mark c UL us - Recognized (OL) |
| CE mark (see declaration of conformity) | to EU directive for EMC to EU directive low-voltage devices in accordance with EU RoHS directive |
| UKCA marking (see declaration of conformity) | To UK instructions for electrical equipment To UK instructions for EMC To UK RoHS instructions |
| Nominal operating voltage DC | 360 V |
| Nominal voltage DC | 360 V |
| Type of winding switch | Star inside |
| Number of pole pairs | 3 |
| Standstill torque | 3.5 Nm |
| Nominal torque | 3.2 Nm |
| Peak torque | 14 Nm |
| Nominal rotary speed | 3,000 1/min |
| Max. speed | 4,627 1/min |
| Nominal motor power | 1,000 W |
| Continuous open-circuit current | 3.9 A |
| Nominal motor current | 3.7 A |
| Peak current | 15.6 A |
| Motor constant | 0.865 Nm/A |
| Voltage constant, phase-to-phase | 55 mVmin |
| Phase-phase winding resistance | 2.8 Ohm |
| Phase-phase winding inductance | 7.43 mH |
| Overall mass moment of inertia at power take-off | 2.2 kgcm ² |
| Product weight | 4,350 g |
| Permissible axial shaft load | 72 N |
| Permissible radial shaft load | 360 N |
| Rotor position sensor | Absolute multi-turn encoder |
| Rotary position encoder interface | HIPERFACE® |
| Rotary position encoder measuring principle | Capacitive |
| Rotor position encoder, sinusoidal/cosinusoidal periods per revolution | 16 |

| Feature | Value |
|--|---|
| Rotor position encoder, typical resolution | 12 Bit |
| Rotor position encoder, typical angular accuracy | 20 arcmin |
| Brake holding torque | 4.5 Nm |
| Operating voltage DC for brake | 24 V |
| Power consumption, brake | 12 W |
| Mass moment of inertia of brake | 0.222 kgcm ² |
| Switching cycles, holding brake | 5 million idle actuations (without work of friction!) |
| MTTF, subcomponent | 797 years, holding brake |
| MTTFd, subcomponent | 271 years, rotary position encoder |
| Energy efficiency | ENEFF (CN) / Class 2 |