

# Semi-rotary drive DRQ-40-90-PPVJ-A

Part number: 19380  
Product to be discontinued

FESTO

For proximity sensing, with adjustable end-position cushioning and backlash-compensating gearing.

Type to be discontinued. Available until 2017. See Support Portal for alternative products.

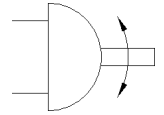
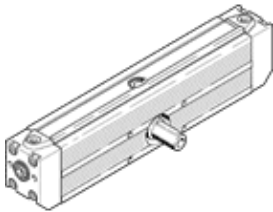

## Data sheet

Feature	Value
Size	40
Cushioning angle	96 deg
Setting range of swivel angle on both sides	-4 /+ 5 deg
Swivel angle	90 deg
Cushioning	PPVJ: Pneumatic cushioning, adjustable
Assembly position	Any
Design structure	Rack and pinion
Position detection	For proximity sensor
Operating pressure	2.5 ... 10 bar
Max. swivel frequency at 6 bar	2.2 Hz
Mode of operation	double-acting
Operating medium	Compressed air in accordance with ISO8573-1:2010 [7:-:-]
Ambient temperature	-10 ... 60 °C
Theoretical torque at 6 bar	9 Nm
Permissible mass moment of inertia	0.005 kgm <sup>2</sup>
Product weight	2,900 g
Mounting type	with internal (female) thread
Pneumatic connection	G1/4
Materials information for drive shaft	Case-hardened steel
Materials information for seals	TPE-U(PU)