

Semi-rotary drive DSM-6-180-P-FW

Part number: 185929

FESTO

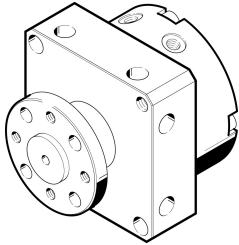

Data sheet

| Feature | Value |
|--|--|
| Size | 6 |
| Cushioning angle | 0.5 deg |
| Swivel angle | 0 deg...180 deg |
| Cushioning | Elastic cushioning rings/plates at both ends |
| Mounting position | optional |
| Mode of operation | Double-acting |
| Design | Vane |
| Position detection | Without |
| Operating pressure | 3.5 bar...8 bar |
| Max. swivel frequency at 0.6 MPa (6 bar, 87 psi) | 3 Hz |
| Operating medium | Compressed air to ISO 8573-1:2010 [7:4:4] |
| Note on operating and pilot medium | Lubricated operation possible (in which case lubricated operation will always be required) |
| LABS (PWIS) conformity | VDMA24364-B1/B2-L |
| Ambient temperature | 0 °C...60 °C |
| Theoretical torque at 0.6 MPa (6 bar, 87 psi) | 0.15 Nm |
| Permissible mass moment of inertia | 0.00065 kgm ² |
| Product weight | 51 g |
| Type of mounting | Via female thread |
| Pneumatic connection | M3 |
| Note on materials | RoHS-compliant |
| Material drive shaft | High-alloy stainless steel |
| Material seals | TPE-U(PU) |
| Material housing | Aluminium Anodised |