

# Ball valve VZBC-100-FF-16-22-F0710-V4V4T

Part number: 1692209

FESTO

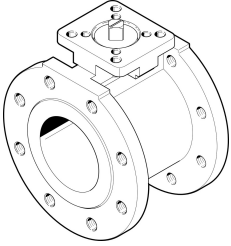

## Data sheet

| Feature                  | Value                             |
|--------------------------|-----------------------------------|
| Design                   | 2-way ball valve                  |
| Type of actuation        | Mechanical                        |
| Sealing principle        | Soft                              |
| Mounting position        | optional                          |
| Type of mounting         | In-line installation              |
| Connection Process valve | Ring housing with threaded flange |

| Feature                                    | Value   |
|--|---|
| Switching position indicator               | Slot direction = flow direction   |
| Flange hole pattern                        | F07<br>F10  |
| Inside diameter                            | 96 mm   |
| Nominal size DN                            | 100   |
| Valve function                             | 2/2   |
| Manual override                            | None  |
| Flow direction                             | Reversible  |
| Nominal pressure PN                        | 16  |
| Actuating torque                           | 148 Nm  |
| Based on standard                          | EN 1092-1<br>ISO 5211   |
| Medium                                     | Compressed air to ISO 8573-1:2010 [-:--:]<br>Inert gases<br>Water – no water vapour<br>Neutral fluids<br>Other media on request |
| Media temperature                          | -10 °C...200 °C   |
| Flow rate Kv                               | 1414 m <sup>3</sup> /h  |
| Note on materials                          | RoHS-compliant  |
| LABS (PWIS) conformity                     | VDMA24364 zone III  |
| Material housing                           | High-alloy stainless steel  |
| Material number housing                    | 1.4408  |
| Material seals                             | PTFE<br>PTFE reinforced   |
| Material ball                              | High-alloy stainless steel  |
| Material number ball                       | 1.4408  |
| Material shaft                             | High-alloy stainless steel  |
| Material number shaft                      | 1.4401  |
| Product weight                             | 20600 g   |
| CE mark (see declaration of conformity)    | In accordance with EU Pressure Equipment Directive  |
| CE marking (see declaration of conformity) | to UK Pressure Equipment Regulations  |
| Explosion protection                       | Zone 1 (ATEX)<br>Zone 2 (ATEX)<br>Zone 21 (ATEX)<br>Zone 22 (ATEX)  |
| Corrosion resistance class CRC             | 3 - high corrosion stress   |