

twin-piston cylinder

DPZJ-20-50-P-A-KF-S20

Part number: 162092

FESTO

With two parallel, double-ended piston rods and yoke plates, for proximity sensing, with elastic cushioning rings in end positions.

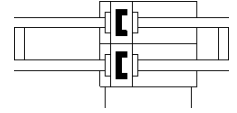
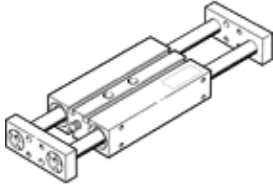

Data sheet

Feature	Value
Stroke	50 mm
Adjustable end-position range/length	10 mm
Piston diameter	20 mm
Operating mode of drive unit	Yoke
Cushioning	P: Flexible cushioning rings/plates at both ends
Assembly position	Any
Guide	Recirculating ball bearing guide
Design structure	Guide
Position detection	For proximity sensor
Variants	through, hollow piston rod
Operating pressure	1 ... 10 bar
Max. speed	1 m/s
Mode of operation	double-acting
Operating medium	Compressed air in accordance with ISO8573-1:2010 [7:4:4]
Note on operating and pilot medium	Lubricated operation possible (subsequently required for further operation)
Corrosion resistance classification CRC	0
Ambient temperature	-20 ... 80 °C
Impact energy in end positions	0.2 Nm
Theoretical force at 6 bar, return stroke	282 N
Theoretical force at 6 bar, advance stroke	282 N
alternative connections	See product drawing
Pneumatic connection	M5
Materials information for cover	Wrought Aluminium alloy
Materials information for seals	NBR
Materials information, housing	Wrought Aluminium alloy
Materials information for piston rod	Case-hardened steel