

# twin-piston cylinder

## DPZJ-10-25-P-A-KF-S2

Part number: 162017

FESTO

With two parallel, double-ended piston rods and yoke plates, for proximity sensing, with elastic cushioning rings in end positions.

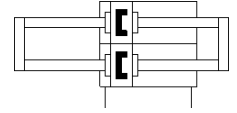
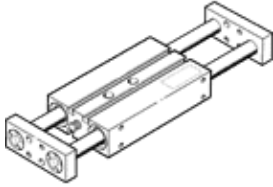

## Data sheet

Feature	Value
Stroke	25 mm
Adjustable end-position range/length	10 mm
Piston diameter	10 mm
Operating mode of drive unit	Yoke
Cushioning	P: Flexible cushioning rings/plates at both ends
Assembly position	Any
Guide	Recirculating ball bearing guide
Design structure	Guide
Position detection	For proximity sensor
Variants	Through piston rod
Operating pressure MPa	0.25 ... 1 MPa
Operating pressure	2.5 ... 10 bar
Max. speed	1 m/s
Mode of operation	double-acting
Operating medium	Compressed air in accordance with ISO8573-1:2010 [7:4:4]
Note on operating and pilot medium	Lubricated operation possible (subsequently required for further operation)
Corrosion resistance classification CRC	0 - No corrosion stress
PWIS conformity	VDMA24364-B1/B2-L
Ambient temperature	-20 ... 80 °C
Impact energy in end positions	0.08 Nm
Theoretical force at 0.6 MPa (6 bar, 87 psi), retracting	60 N
Theoretical force at 0.6 MPa (6 bar, 87 psi), advance	60 N
alternative connections	See product drawing
Pneumatic connection	M5
Material cover	Wrought Aluminium alloy
Material seals	NBR
Material housing	Wrought Aluminium alloy
Material piston rod	Case-hardened steel