

# flat cylinder DZH-50-40-PPV-A

Part number: 14064

FESTO

Non-rotating, for proximity sensing, with adjustable cushioning at both ends. Various mounting options, with or without additional mounting components.

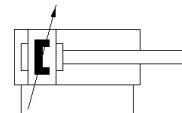
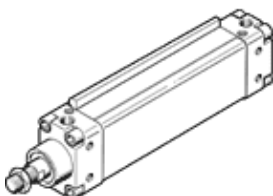

## Data sheet

| Feature  | Value   |
|--|---|
| Stroke   | 40 mm   |
| Piston diameter  | 50 mm   |
|  | Equivalent diameter   |
| Max. angular deflection of piston rod +/-                | 0.75 deg  |
| Cushioning   | PPV: Pneumatic cushioning adjustable at both ends                           |
| Assembly position  | Any   |
| Mode of operation  | double-acting   |
| Design structure   | Piston<br>Piston rod  |
| Position detection                                       | For proximity sensor  |
| Protection against torque/guide                          | Oval piston   |
| Operating pressure MPa                                   | 0.06 ... 1 MPa  |
| Operating pressure                                       | 0.6 ... 10 bar  |
| Operating medium   | Compressed air in accordance with ISO8573-1:2010 [7:4:4]                    |
| Note on operating and pilot medium                       | Lubricated operation possible (subsequently required for further operation) |
| Corrosion resistance classification CRC                  | 2 - Moderate corrosion stress   |
| PWIS conformity  | VDMA24364-B2-L  |
| Ambient temperature                                      | -20 ... 80 °C   |
| Cushioning length  | 23 mm   |
| Max. torque for protection against rotation              | 1.7 Nm  |
| Theoretical force at 0.6 MPa (6 bar, 87 psi), retracting | 989.6 N   |
| Theoretical force at 0.6 MPa (6 bar, 87 psi), advance    | 1,178 N   |
| Additional weight per 10 mm stroke                       | 60 g  |
| Basic weight for 0 mm stroke                             | 1,200 g   |
| Mounting type  | with internal (female) thread<br>with accessories<br>Optional               |
| Pneumatic connection                                     | G1/4  |
| Materials note   | Conforms to RoHS  |
| Material cover   | Aluminium   |
| Material seals   | TPE-U(PU)   |
| Material housing   | Aluminium   |
| Material piston rod                                      | High alloy steel  |