

# standards-based cylinder

## DSBC-40-250-PPVA-N3

Part number: 1376664

★ Core product range

With adjustable cushioning at both ends.

FESTO

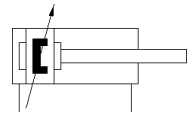
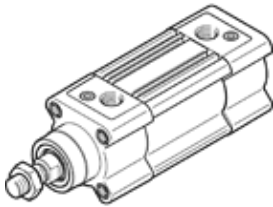

## Data sheet

| Feature  | Value   |
|--|---|
| Stroke   | 250 mm  |
| Piston diameter  | 40 mm   |
| Piston rod thread  | M12x1,25  |
| Cushioning   | PPV: Pneumatic cushioning adjustable at both ends                           |
| Assembly position  | Any   |
| Conforms to standard                                     | ISO 15552   |
| Piston-rod end   | Male thread   |
| Design structure   | Piston<br>Piston rod<br>Profile barrel                                      |
| Position detection                                       | For proximity sensor  |
| Variants   | Single-ended piston rod   |
| Operating pressure MPa                                   | 0.06 ... 1.2 MPa  |
| Operating pressure                                       | 0.6 ... 12 bar  |
| Mode of operation  | double-acting   |
| Operating medium   | Compressed air in accordance with ISO8573-1:2010 [7:4:4]                    |
| Note on operating and pilot medium                       | Lubricated operation possible (subsequently required for further operation) |
| Corrosion resistance classification CRC                  | 2 - Moderate corrosion stress   |
| PWIS conformity  | VDMA24364-B1/B2-L   |
| Cleanroom class  | ISO class 6   |
| Ambient temperature                                      | -20 ... 80 °C   |
| Impact energy in end positions                           | 0.7 J   |
| Cushioning length  | 19 mm   |
| Theoretical force at 0.6 MPa (6 bar, 87 psi), retracting | 633 N   |
| Theoretical force at 0.6 MPa (6 bar, 87 psi), advance    | 754 N   |
| Moving mass with 0 mm stroke                             | 205 g   |
| Additional mass factor per 10 mm of stroke               | 16 g  |
| Basic weight for 0 mm stroke                             | 740 g   |
| Additional weight per 10 mm stroke                       | 37 g  |
| Mounting type  | with internal (female) thread<br>with accessories<br>Optional               |
| Pneumatic connection                                     | G1/4  |
| Materials note   | Conforms to RoHS  |
| Material cover   | Die-cast aluminium, coated  |
| Material piston seal                                     | TPE-U(PU)   |
| Material piston  | Wrought Aluminium alloy   |
| Material piston rod                                      | High alloy steel  |
| Material piston rod wiper seal                           | TPE-U(PU)   |
| Buffer seal material                                     | TPE-U(PU)   |
| Cushion piston material                                  | POM   |
| Material cylinder barrel                                 | Smooth-anodised wrought aluminium alloy                                     |
| Material nut   | steel, galvanized   |
| Material bearing   | POM   |
| Material of flange screw                                 | steel, galvanized   |