

# stepper motor EMMS-ST-57-M-SB-G2

Part number: 1370480

★ Core product range

Without gear unit/with brake.

FESTO

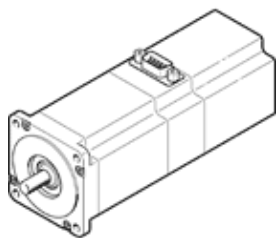

## Data sheet

| Feature  | Value   |
|--|---|
| Ambient temperature                              | -10 ... 50 °C   |
| Storage temperature                              | -20 ... 70 °C   |
| Relative air humidity                            | 0 - 85 %  |
| Conforms to standard                             | IEC 60034   |
| Insulation protection class                      | B   |
| Thermal class according to EN 60034-1            | B   |
| Rating class according to EN 60034-1             | S1  |
| Protection class                                 | IP54  |
| Electrical connector system                      | Plug  |
| Materials note                                   | Conforms to RoHS                                      |
| Corrosion resistance classification CRC          | 1 - Low corrosion stress                              |
| PWIS conformity                                  | VDMA24364-B2-L  |
| Authorisation                                    | RCM Mark<br>c UL us - Recognized (OL)                 |
| CE mark (see declaration of conformity)          | to EU directive for EMC                               |
| UKCA marking (see declaration of conformity)     | To UK instructions for EMC<br>To UK RoHS instructions |
| Nominal operating voltage DC                     | 48 V  |
| Motor holding torque                             | 1.4 Nm  |
| Max. speed                                       | 1,940 1/min   |
| Stepper angle at full step                       | 1.8 deg   |
| Stepper angle tolerance                          | ±5 %  |
| Nominal motor current                            | 5 A   |
| Voltage constant, phase                          | 25.5 mVmin  |
| Winding resistance phase                         | 0.25 Ohm  |
| Winding inductance phase                         | 0.95 mH   |
| Mass moment of inertia of rotor                  | 0.48 kgcm <sup>2</sup>                                |
| Overall mass moment of inertia at power take-off | 0.5 kgcm <sup>2</sup>                                 |
| Product weight                                   | 1,320 g   |
| Permissible axial shaft load                     | 10 N  |
| Permissible radial shaft load                    | 52 N  |
| Brake holding torque                             | 1 Nm  |
| Operating voltage DC for brake                   | 24 V  |
| Power consumption, brake                         | 10 W  |
| Mass moment of inertia of brake                  | 0.02 kgcm <sup>2</sup>                                |