

semi-rotary drive DSM-T-40-270-CC-A-B

Part number: 1145112

FESTO

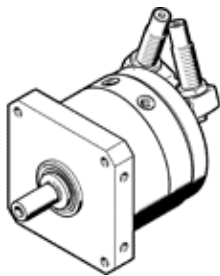

Data sheet

Feature	Value
Size	40
Cushioning angle	16 deg
Rotation angle adjustment range	0 ... 240 deg
Swivel angle	0 ... 240 deg
Cushioning	CC: Shock absorber at both ends
Assembly position	Any
Fine adjustment	-3 deg
Mode of operation	double-acting
Design structure	Rotary vane
Position detection	For proximity sensor
Operating pressure MPa	0.2 ... 1 MPa
Operating pressure	2 ... 10 bar
Max. swivel frequency at 0.6 MPa (6 bar, 87 psi)	0.7 Hz
Operating medium	Compressed air in accordance with ISO8573-1:2010 [7:::]
Corrosion resistance classification CRC	0 - No corrosion stress
PWIS conformity	VDMA24364-B2-L
Ambient temperature	-10 ... 60 °C
Max. axial force	120 N
Max. radial force	350 N
Theoretical torque at 0.6 MPa (6 bar, 87 psi)	40 Nm
Permissible mass moment of inertia	0.11 kgm ²
Product weight	3,970 g
Mounting type	with internal (female) thread
Pneumatic connection	G1/8
Materials note	Conforms to RoHS
Material of drive shaft	Steel Nickel plated
Material seals	TPE-U(PU)
Material housing	Wrought Aluminium alloy