

# 穿板式快擰接頭

## SCK-PK-6

料號: 9422

FESTO

金屬結構

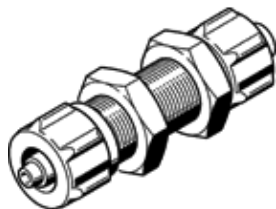

### 技術參數

特性	值
額定尺寸	5.3 mm
裝配位置	任何
設計	Bulkhead
容器尺寸	10
Operating pressure for entire temperature range	-0.095 ... 1 MPa
操作壓力的完整溫度範圍	-0.95 ... 10 bar
Operating pressure for entire temperature range	-13.775 ... 145 psi
操作介質	壓縮空氣符合 ISO8573-1:2010 [7:-:-]
注意: 操作和嚮導介質	潤滑操作可行
耐腐蝕等級 CRC	1 - Low corrosion stress
PWIS conformity	VDMA24364-B1/B2-L
環境溫度	-10 ... 60 °C
氣壓連接, 氣口 1	For tubing outside diameter 8 mm 用於倒鉤接頭內徑 6 mm 具螺母
氣壓連接, 氣口 2	For tubing outside diameter 8 mm 用於倒鉤接頭內徑 6 mm 具螺母
Material of union nut	Anodised wrought aluminium alloy
材料備註	符合 RoHS
Material nut	鋼, 鍍鋅
Material – connector	Anodised wrought aluminium alloy