

# 伺服馬達

## EMMT-AS-100-H-HS-RM

料號: 8182016  
新

FESTO

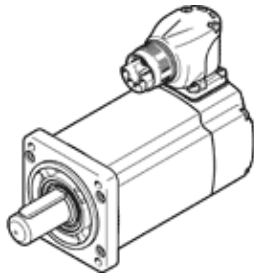

### 技術參數

| 特性  | 值  |
|---|--|
| 環境溫度  | -15 ... 40 °C  |
| Note on ambient temperature                               | Up to 80° C with derating of -1.75% per degree Celsius   |
| Max. installation height                                  | 4,000 m  |
| Note on max. installation height                          | As of 1,000 m, only with derating of -1.0% per 100 m   |
| 儲藏溫度  | -20 ... 70 °C  |
| 相對空氣濕度  | 0 - 90 %   |
| 符合標準  | IEC 60034  |
| 根據EN60034-1的熱量等級  | F  |
| Max. winding temperature                                  | 155 °C   |
| 根據EN60034-1的速率等級  | S1   |
| 溫度監控  | Digital motor temperature transmission via EnDat® 2.2  |
| Motor type to EN 60034-7                                  | IM B5<br>IM V1<br>IM V3  |
| 裝配位置  | 任何   |
| 防護等級  | IP40   |
| Note on degree of protection                              | IP40 motor shaft without RWDR<br>IP65 motor shaft with RWDR<br>IP67 for motor housing with connection technology |
| Concentricity, coaxiality, axial runout to DIN SPEC 42955 | N  |
| Balance quality   | G 2,5  |
| Detent torque   | <1.0% of peak torque   |
| Storage lifetime under nominal conditions                 | 20,000 h   |
| Interface code, motor out                                 | 100A   |
| Electrical connection 1, connection type                  | Hybrid plugs   |
| Electrical connection 1, connection technology            | M23x1  |
| Electrical connection 1, number of pins/wires             | 15   |
| 污染程度  | 2  |
| 材料備註  | 符合 RoHS  |
| 耐腐蝕等級 CRC   | 0 - No corrosion stress  |
| PWIS conformity   | VDMA24364 zone III   |
| 耐振動   | 傳送應用測試在安全等級 2 符合 FN 942017-4 及 EN 60068-2-6  |
| 耐衝擊   | Shock test with severity level 2 in accordance with FN 942017-5 and EN 60068-2-27                                |
| 授權  | RCM Mark<br>c UL us - Recognized (OL)  |
| CE 符號 (參見符合的標準)   | 根據 EU-EMV 指導原則<br>根據 EU 低電壓設備指導原則<br>in accordance with EU RoHS directive  |
| UKCA marking (see declaration of conformity)              | To UK instructions for electrical equipment<br>To UK instructions for EMC<br>To UK RoHS instructions             |
| 認證核發部門  | UL E342973   |
| 額定工作電壓 DC   | 680 V  |
| Type of winding switch                                    | Star inside  |
| Number of pole pairs                                      | 5  |

| 特性  | 值                                |
|---|----------------------------------|
| 靜止扭矩  | 13 Nm                            |
| 額定扭矩  | 7.8 Nm                           |
| 峰值 (最大) 扭矩  | 38.7 Nm                          |
| 額定擺動速度  | 2,700 1/min                      |
| 最高速度  | 5,150 1/min                      |
| Max. mechanical speed                                       | 13,000 1/min                     |
| 額定馬達功率  | 2,200 W                          |
| 連續的開路電流   | 9.7 A                            |
| 額定馬達電流  | 5.9 A                            |
| 峰值 (最大) 電流  | 36 A                             |
| 馬達恆定  | 1.32 Nm/A                        |
| Standstill torque constant                                  | 1.54 Nm/A                        |
| Voltage constant, phase-to-phase                            | 93.2 mVmin                       |
| Phase-phase winding resistance                              | 0.81 Ohm                         |
| Phase-phase winding inductance                              | 9 mH                             |
| Winding longitudinal inductivity Ld (phase)                 | 5.7 mH                           |
| Winding cross inductivity Lq (phase)                        | 6.8 mH                           |
| Electric time constant                                      | 16.7 ms                          |
| Thermal time constant                                       | 68 min                           |
| Thermal resistance  | 0.39 K/W                         |
| Measuring flange  | 300 x 300 x 20, steel            |
| 斷電時轉動慣量總和   | 8.8 kgcm <sup>2</sup>            |
| 產品重量  | 11,900 g                         |
| 容許的軸向驅動軸負載  | 200 N                            |
| 容許的徑向軸負載  | 815 N                            |
| 轉子位置感測器   | Absolute multi-turn encoder      |
| Rotor position sensor, manufacturer designation             | EQI 1331                         |
| Rotor position sensor, absolute detectable revolutions      | 4,096                            |
| Rotary position encoder interface                           | EnDat 22                         |
| Rotary position encoder measuring principle                 | 電感式                              |
| Rotor position sensor, DC operating voltage                 | 5 V                              |
| Rotor position sensor, DC operating voltage range           | 3.6 ... 14 V                     |
| Rotor position sensor, position values per revolution       | 524,288                          |
| 轉子位置編碼器起動裝置   | 19 Bit                           |
| Rotor position sensor, system accuracy of angle measurement | -65 ... 65 arcsec                |
| MTTF, subcomponent  | 190 years, rotor position sensor |
| Energy efficiency   | ENEFF (CN) / Class 2             |