

伺服馬達 EMME-AS-80-M-HS-AMB

料號: 2093203
將停止供貨的產品

不具齒輪元件/具制動

FESTO

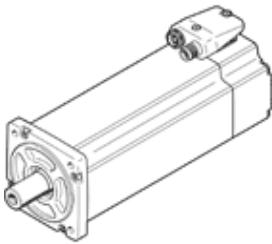

技術參數

| 特性 | 值 |
|--|--|
| 環境溫度 | -10 ... 40 °C |
| 儲藏溫度 | -20 ... 70 °C |
| 相對空氣濕度 | 0 - 90 % |
| 符合標準 | IEC 60034 |
| 絕緣保護等級 | F |
| 根據EN60034-1的速率等級 | S1 |
| 防護等級 | IP21 |
| 電接頭系統 | 插頭 |
| 材料備註 | 符合 RoHS |
| 耐腐蝕等級 CRC | 0 - No corrosion stress |
| PWIS conformity | VDMA24364 zone III |
| 授權 | RCM Mark c UL us - Recognized (OL) |
| CE 符號 (參見符合的標準) | 根據 EU-EMV 指導原則 根據 EU 低電壓設備指導原則 in accordance with EU RoHS directive |
| UKCA marking (see declaration of conformity) | To UK instructions for electrical equipment To UK instructions for EMC To UK RoHS instructions |
| 額定工作電壓 DC | 565 V |
| 額定電壓 DC | 565 V |
| Type of winding switch | Star inside |
| Number of pole pairs | 3 |
| 靜止扭矩 | 3.5 Nm |
| 額定扭矩 | 3.2 Nm |
| 峰值 (最大) 扭矩 | 14 Nm |
| 額定擺動速度 | 3,000 1/min |
| 最高速度 | 4,097 1/min |
| 額定馬達功率 | 1,000 W |
| 連續的開路電流 | 2.2 A |
| 額定馬達電流 | 2.1 A |
| 峰值 (最大) 電流 | 8.8 A |
| 馬達恆定 | 1.524 Nm/A |
| Voltage constant, phase-to-phase | 97.5 mVmin |
| Phase-phase winding resistance | 9 Ohm |
| Phase-phase winding inductance | 22.8 mH |
| 斷電時轉動慣量總和 | 2.2 kgcm ² |
| 產品重量 | 4,350 g |
| 容許的軸向驅動軸負載 | 72 N |
| 容許的徑向軸負載 | 360 N |
| 轉子位置感測器 | Absolute multi-turn encoder |
| Rotary position encoder interface | HIPERFACE® |
| Rotary position encoder measuring principle | Capacitive |
| Rotor position encoder, sinusoidal/cosinusoidal periods per revolution | 16 |

| 特性 | 值 |
|--|---|
| Rotor position encoder, typical resolution | 12 Bit |
| Rotor position encoder, typical angular accuracy | 20 arcmin |
| 剎車保持扭矩 | 4.5 Nm |
| 制動裝置的DC工作電壓 | 24 V |
| 制動裝置的電力消耗 | 12 W |
| 剎車的質量慣性力矩 | 0.222 kgcm ² |
| Switching cycles, holding brake | 5 million idle actuations (without work of friction!) |
| MTTF, subcomponent | 797 years, holding brake |
| MTTFd, subcomponent | 271 years, rotary position encoder |
| Energy efficiency | ENEFF (CN) / Class 2 |