

# Common supply manifold

## PAL-5-1/4-3

Part number: 9189

FESTO

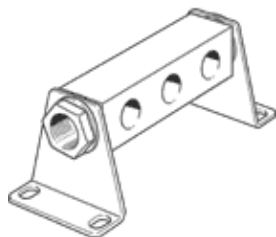

### Data sheet

| Feature                        | Value                 |
|--------------------------------|-----------------------|
| Max. number of valve positions | 3                     |
| PWIS conformity                | VDMA24364-B1/B2-L     |
| Product weight                 | 405 g                 |
| Mounting type                  | With mounting bracket |
| Pneumatic connection, port 1   | G3/8                  |
| Materials note                 | Conforms to RoHS      |
| Material of connecting plate   | Aluminum              |