

# Guide cylinder

## DFM-N-50-80-B-P-A-GF

Part number: 570596  
Product to be discontinued

FESTO

With integral guide.

The proximity switch, type SMTSO-8E, can be used with this product with stroke lengths equal to or greater than 50 mm. The corresponding mounting kit, type SMB-8E, is mounted inwardly or outwardly.

Type to be discontinued. Available until 2022. See Support Portal for alternative products.

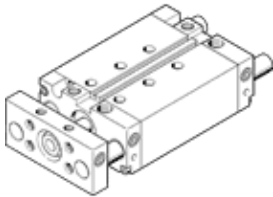

## Data sheet

| Feature  | Value   |
|--|---|
| Stroke   | 80 mm   |
| Piston diameter  | 50 mm   |
| Operating mode of drive unit                             | Yoke  |
| Cushioning   | P: Flexible cushioning rings/plates at both ends                            |
| Assembly position  | Any   |
| Guide  | Plain-bearing guide   |
| Design structure   | Guide   |
| Position detection                                       | For proximity sensor  |
| Working pressure   | 1 ... 10 bar  |
| Mode of operation  | double-acting   |
| Operating medium   | Compressed air in accordance with ISO8573-1:2010 [7:4:4]                    |
| Note on operating and pilot medium                       | Lubricated operation possible (subsequently required for further operation) |
| Corrosion resistance classification CRC                  | 2 - Moderate corrosion stress   |
| Ambient temperature                                      | -20 ... 80 °C   |
| Theoretical force at 0.6 MPa (6 bar, 87 psi), retracting | 1,057 N   |
| Theoretical force at 0.6 MPa (6 bar, 87 psi), advance    | 1,178 N   |
| alternative connections                                  | See product drawing   |
| Pneumatic connection                                     | 1/4 NPT   |
| Materials note   | Conforms to RoHS  |
| Material cover   | Wrought Aluminum alloy  |
| Material seals   | NBR   |
| Material housing   | Wrought Aluminum alloy  |
| Material piston rod                                      | High alloy steel, non-corrosive   |