

Guide cylinder

DFM-N-40-160-B-P-A-GF

Part number: 570592
Product to be discontinued

FESTO

With integral guide.

The proximity switch, type SMTSO-8E, can be used with this product with stroke lengths equal to or greater than 50 mm. The corresponding mounting kit, type SMB-8E, is mounted inwardly or outwardly.

Type to be discontinued. Available until 2022. See Support Portal for alternative products.

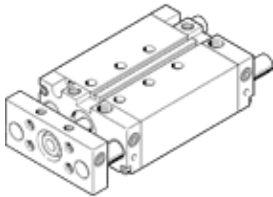

Data sheet

| Feature | Value |
|--|---|
| Stroke | 160 mm |
| Piston diameter | 40 mm |
| Operating mode of drive unit | Yoke |
| Cushioning | P: Flexible cushioning rings/plates at both ends |
| Assembly position | Any |
| Guide | Plain-bearing guide |
| Design structure | Guide |
| Position detection | For proximity sensor |
| Working pressure | 1.5 ... 10 bar |
| Mode of operation | double-acting |
| Operating medium | Compressed air in accordance with ISO8573-1:2010 [7:4:4] |
| Note on operating and pilot medium | Lubricated operation possible (subsequently required for further operation) |
| Corrosion resistance classification CRC | 2 - Moderate corrosion stress |
| Ambient temperature | -20 ... 80 °C |
| Theoretical force at 0.6 MPa (6 bar, 87 psi), retracting | 686 N |
| Theoretical force at 0.6 MPa (6 bar, 87 psi), advance | 754 N |
| alternative connections | See product drawing |
| Pneumatic connection | 1/8 NPT |
| Materials note | Conforms to RoHS |
| Material cover | Wrought Aluminum alloy |
| Material seals | NBR |
| Material housing | Wrought Aluminum alloy |
| Material piston rod | High alloy steel, non-corrosive |