

Stepper motor MTRE-ST-42-48S-AB

Part number: 530060

FESTO

With integrated controller and brake.

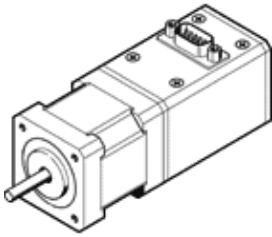

Data sheet

Feature	Value
Stepper angle at full step	1.8 deg
Stepper angle tolerance	±5%
Operating voltage DC for brake	24 V
Operating voltage range DC	24 ... 48 V
Insulation protection class	B
Power consumption, brake	6 W
Nominal voltage DC	48 V
Nominal motor current	1.2 A
CE symbol (see declaration of conformity)	according to EU-EMV guideline
Storage temperature	-25 ... 60 °C
Relative air humidity	45 - 80 %
Protection class	IP54
Ambient temperature	0 ... 50 °C
Authorization	C-Tick
Overall mass moment of inertia at power take-off	0.07 kgcm ²
Brake holding torque	0.4 Nm
Motor holding torque	0.34 Nm
Mass moment of inertia of brake	0.002 kgcm ²
Mass moment of inertia of rotor	0.068 kgcm ²
Permissible axial shaft load	7 N
Permissible radial shaft load	18 N
Product weight	550 g
Electrical connector system	Plug