

# Servomotor EMME-AS-60-SK-LS-AMXB

Part number: 4267575  
Product to be discontinued

FESTO

Without gear unit/with brake.

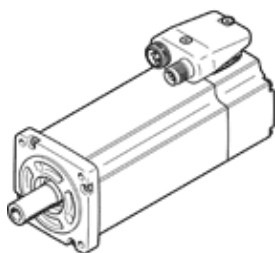

## Data sheet

| Feature  | Value  |
|--|--|
| Ambient temperature                              | -10 ... 40 °C  |
| Storage temperature                              | -20 ... 70 °C  |
| Relative air humidity                            | 0 - 90 %   |
| Conforms to standard                             | IEC 60034  |
| Insulation protection class                      | F  |
| Rating class according to EN 60034-1             | S1   |
| Protection class                                 | IP21   |
| Shaft design Featherkey                          | DIN 6885<br>A 5 x 5 x 22   |
| Electrical connector system                      | Plug   |
| Materials note                                   | Conforms to RoHS   |
| Corrosion resistance classification CRC          | 0 - No corrosion stress  |
| PWIS conformity                                  | VDMA24364 zone III   |
| Authorization                                    | RCM Mark<br>c UL us - Recognized (OL)  |
| CE symbol (see declaration of conformity)        | according to EU-EMV guideline<br>according to EU low voltage guideline<br>in accordance with EU RoHS directive |
| UKCA marking (see declaration of conformity)     | To UK instructions for electrical equipment<br>To UK instructions for EMC<br>To UK RoHS instructions           |
| Nominal operating voltage DC                     | 360 V  |
| Nominal voltage DC                               | 360 V  |
| Type of winding switch                           | Star inside  |
| Number of pole pairs                             | 3  |
| Standstill torque                                | 0.7 Nm   |
| Nominal torque                                   | 0.6 Nm   |
| Peak torque                                      | 2.8 Nm   |
| Nominal rotary speed                             | 3,000 1/min  |
| Max. speed                                       | 5,131 1/min  |
| Nominal motor power                              | 190 W  |
| Continuous open-circuit current                  | 0.9 A  |
| Nominal motor current                            | 0.8 A  |
| Peak current                                     | 3.6 A  |
| Motor constant                                   | 0.75 Nm/A  |
| Voltage constant, phase-to-phase                 | 49.6 mV/min  |
| Phase-phase winding resistance                   | 26.4 Ohm   |
| Phase-phase winding inductance                   | 31.9 mH  |
| Overall mass moment of inertia at power take-off | 0.319 kgcm <sup>2</sup>  |
| Product weight                                   | 1,650 g  |
| Permissible axial shaft load                     | 50 N   |
| Permissible radial shaft load                    | 250 N  |
| Rotor position sensor                            | Safety Enc. absolut multi turn   |
| Rotary position encoder interface                | HIPERFACE®   |

| Feature  | Value  |
|--|--|
| Rotary position encoder measuring principle                            | Optical  |
| Rotor position encoder, sinusoidal/cosinusoidal periods per revolution | 128  |
| Rotor position encoder, typical resolution                             | 15 Bit   |
| Rotor position encoder, typical angular accuracy                       | 20 arcmin  |
| Brake holding torque   | 2 Nm   |
| Operating voltage DC for brake   | 24 V   |
| Power consumption, brake   | 11 W   |
| Mass moment of inertia of brake  | 0.086 kgcm <sup>2</sup>  |
| Switching cycles, holding brake  | 5 million idle actuations (without work of friction!)            |
| Safety Integrity Level (SIL), component parts                          | SIL 2, rotor position encoder<br>SILCL 2, rotor position encoder |
| Performance Level (PL), component parts                                | Category 3, Performance Level d, rotor position encoder          |
| PFHd, component parts  | 1.3 x 10E-8, rotor position encoder                              |
| Duration of use Tm, component parts                                    | 20 years, rotor position encoder                                 |
| MTTF, subcomponent   | 538 years, holding brake   |
| MTTFd, subcomponent  | 874 years, rotor position encoder                                |