

Semi-rotary actuator DRQ-40-180-PPVJ-A

Part number: 19381
Product to be discontinued

FESTO

For proximity sensing, with adjustable end position cushioning and backlash-compensating gearing.

Type to be discontinued. Available until 2017. See Support Portal for alternative products.

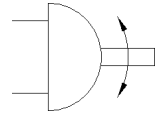
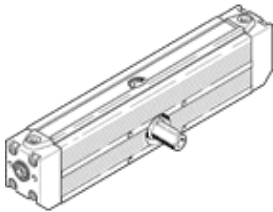

Data sheet

| Feature | Value |
|---|--|
| Size | 40 |
| Cushioning angle | 96 deg |
| Setting range of swivel angle on both sides | -4 /+ 5 deg |
| Swivel angle | 180 deg |
| Cushioning | PPVJ: Pneumatic cushioning, adjustable |
| Assembly position | Any |
| Design structure | Rack and pinion |
| Position detection | For proximity sensor |
| Working pressure | 2.5 ... 10 bar |
| Max. swivel frequency at 6 bar | 2.3 Hz |
| Mode of operation | double-acting |
| Operating medium | Compressed air in accordance with ISO8573-1:2010 [7:-:-] |
| Ambient temperature | -10 ... 60 °C |
| Theoretical torque at 6 bar | 9 Nm |
| Permissible mass moment of inertia | 0.005 kgm ² |
| Product weight | 3,220 g |
| Mounting type | with internal (female) thread |
| Pneumatic connection | G1/4 |
| Materials information for drive shaft | Case-hardened steel |
| Materials information for seals | TPE-U(PU) |