

Connector block CPE18-PRSEO-2

Part number: 187832

Classic - do not use for new projects

FESTO

For Compact Performance valves with open PRS ducts.

Only fittings with a G connection may be used with this manifold.

Modern alternatives can be found by entering the first four characters of the type code in the search field.

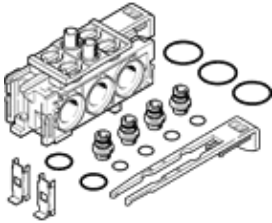

Data sheet

Feature	Value
Max. number of valve positions	2
Operating medium	Compressed air in accordance with ISO8573-1:2010 [7:4:4]
Note on operating and pilot medium	Lubricated operation possible (subsequently required for further operation)
Corrosion resistance classification CRC	2 - Moderate corrosion stress
PWIS conformity	VDMA24364-B1/B2-L
Product weight	145 g
Mounting method for subbase	with through hole with top-hat rail
Pneumatic connection, port 1	G1/2
Materials note	Conforms to RoHS
Material housing	PA-reinforced