

# Swivel/linear unit DSL-20-40-270-P-S20-FF-KF

Part number: 177189

FESTO

For proximity sensing. Rotary and linear movement can be actuated simultaneously or independently of one another. Rotary movement of 0° - 270° infinitely adjustable.

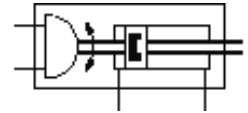
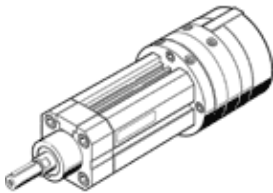

## Data sheet

Feature	Value
Cushioning angle	2.1 deg
Rotation angle adjustment range	270 deg
Stroke	40 mm
Piston diameter	20 mm
Swivel angle	272 deg
Cushioning	P: Flexible cushioning rings/plates at both ends
Assembly position	Any
Fine adjustment	5 deg
Mode of operation	double-acting
Design structure	Rotary vane
Position detection	For inductive sensors For proximity sensor
Variants	S20: through, hollow piston rod
Protection against torque/guide	with ball-bearing guide
Operating pressure	2.5 ... 8 bar
Max. impact speed	500 mm/s
Max. swivel frequency at 6 bar	2 Hz
Operating medium	Dried compressed air, lubricated or unlubricated
Ambient temperature	-10 ... 60 °C
Cushioning length	5 mm
Torque at 6 bar	2.5 Nm
Theoretical force at 6 bar, return stroke	120.5 N
Theoretical force at 6 bar, advance stroke	158 N
Permissible mass moment of inertia	0.00007 kgm <sup>2</sup>
Additional weight per 10 mm stroke	52 g
Basic weight for 0 mm stroke	1,140 g
Product weight	1,140 g
Mounting type	Clamped in T-slot with external (male) thread Optional
Pneumatic connection	M5
Materials information for cover	Wrought Aluminum alloy Anodized
Materials information for seals	TPE-U(PU)
Materials information, housing	Wrought Aluminum alloy Smooth anodized
Materials information for piston rod	Heat-treatment steel