

Connector block CPE10-PRSE-2

Part number: 164962

Classic - do not use for new projects

FESTO

For Compact Performance valves with closed PRS ducts.

Only fittings with a G connection may be used with this manifold.

Modern alternatives can be found by entering the first four characters of the type code in the search field.

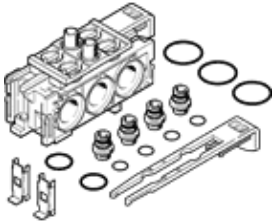

Data sheet

Feature	Value
Max. number of valve positions	2
Operating medium	Compressed air in accordance with ISO8573-1:2010 [7:4:4]
Note on operating and pilot medium	Lubricated operation possible (subsequently required for further operation)
Corrosion resistance classification CRC	2 - Moderate corrosion stress
Product weight	40 g
Mounting method for subbase	with through hole with top-hat rail
Pneumatic connection, port 1	G1/4
Materials note	Free of copper and PTFE Conforms to RoHS
Material housing	PA-reinforced