

Guide unit SPZ-16-100-P-A-S6

Part number: 159739

FESTO

With 2 piston rods (Twin slide), for proximity sensing.

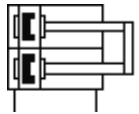
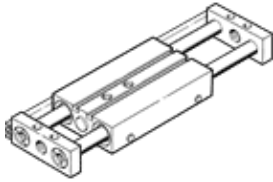

Data sheet

Feature	Value
Stroke	100 mm
Adjustable end-position range/length	10 mm
Piston diameter	16 mm
Operating mode of drive unit	Slide
Cushioning	P: Flexible cushioning rings/plates at both ends
Assembly position	Any
Guide	Plain-bearing guide
Design structure	Guide
Position detection	For proximity sensor
Variants	S6: heat-resistant seals to max. 120 °C
Working pressure	1 ... 10 bar
Mode of operation	double-acting
Operating medium	Dried compressed air, lubricated or unlubricated
Corrosion resistance classification CRC	2
Ambient temperature	-20 ... 120 °C
Theoretical force at 6 bar, return stroke	180 N
Theoretical force at 6 bar, advance stroke	180 N
Pneumatic connection	M5
Materials information for cover	Wrought Aluminum alloy
Materials information for seals	FPM
Materials information, housing	Wrought Aluminum alloy
Materials information for piston rod	High alloy steel, non-corrosive