

Compact cylinder

EMM-20-10-P-A

Part number: 158623

FESTO

For proximity sensing, numerous mounting options ("Multimount"), with end position cushioning.

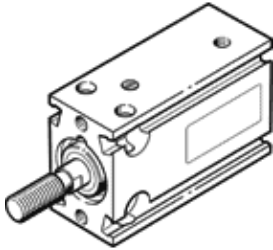

Data sheet

| Feature | Value |
|--|---|
| Stroke | 10 mm |
| Piston diameter | 20 mm |
| Cushioning | P: Flexible cushioning rings/plates at both ends |
| Assembly position | Any |
| Mode of operation | single-acting pushing action |
| Design structure | Piston Piston rod Profile barrel |
| Position detection | For proximity sensor |
| Variants | Single-ended piston rod |
| Working pressure | 1.5 ... 10 bar |
| Operating medium | Compressed air in accordance with ISO8573-1:2010 [7:4:4] |
| Note on operating and pilot medium | Lubricated operation possible (subsequently required for further operation) |
| Corrosion resistance classification CRC | 2 - Moderate corrosion stress |
| Ambient temperature | -20 ... 80 °C |
| Tightening torque of the drive mounting | 3 Nm +10% |
| Theoretical force at 6 bar | 165 N |
| Theoretical force at 6 bar, advance stroke | 165 N |
| Mounting type | Optional with through hole with internal (female) thread |
| Pneumatic connection | M5 |
| Material cover | Brass |
| Material seals | TPE-U(PU) |
| Material housing | Wrought Aluminum alloy Anodized |
| Material piston rod | High alloy steel, non-corrosive |