

# Compact cylinder ADVUL-25-50-P-A

Part number: 156873  
Classic - do not use for new projects

FESTO

For proximity sensing. Piston rod secured against rotation by means of guide rod and yoke plate.

Modern alternatives can be found by entering the first four characters of the type code in the search field.

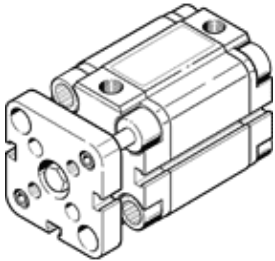

## Data sheet

| Feature  | Value   |
|--|---|
| Stroke   | 50 mm   |
| Piston diameter  | 25 mm   |
| Cushioning   | P: Flexible cushioning rings/plates at both ends                            |
| Assembly position  | Any   |
| Design structure   | Piston<br>Piston rod  |
| Position detection                                       | For proximity sensor  |
| Variants   | Single-ended piston rod   |
| Protection against torque/guide                          | Guide rod with yoke   |
| Operating pressure MPa                                   | 0.1 ... 1 MPa   |
| Working pressure   | 1 ... 10 bar  |
| Mode of operation  | double-acting   |
| Operating medium   | Compressed air in accordance with ISO8573-1:2010 [7:4:4]                    |
| Note on operating and pilot medium                       | Lubricated operation possible (subsequently required for further operation) |
| Corrosion resistance classification CRC                  | 2 - Moderate corrosion stress   |
| PWIS conformity  | VDMA24364-B1/B2-L   |
| Ambient temperature                                      | -20 ... 80 °C   |
| Impact energy in end positions                           | 0.1 J   |
| Theoretical force at 0.6 MPa (6 bar, 87 psi), retracting | 247 N   |
| Theoretical force at 0.6 MPa (6 bar, 87 psi), advance    | 295 N   |
| Mounting type  | with through hole<br>with accessories<br>Optional                           |
| Pneumatic connection                                     | M5  |
| Material of flange screw                                 | steel, galvanized   |
| Material cover   | Wrought Aluminum alloy  |
| Material of dynamic seals                                | NBR<br>TPE-U(PU)  |
| Material piston rod                                      | High alloy steel, non-corrosive   |
| Material cylinder barrel                                 | Wrought Aluminum alloy  |