

Quick coupling socket KDMS6-1/4-A

Part number: 151776

FESTO

Self-closing, for safety coupling per ISO 4414

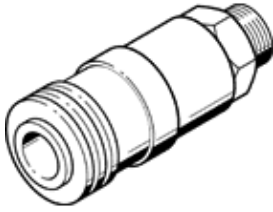

Data sheet

Feature	Value
Nominal size	8 mm
Pressure gauge	Optical
Operating pressure complete temperature range	-0.95 ... 12 bar
Standard nominal flow rate	1,742 l/min
Operating medium	Compressed air in accordance with ISO8573-1:2010 [7:-:-]
Note on operating and pilot medium	Lubricated operation possible
Corrosion resistance classification CRC	1
Ambient temperature	-10 ... 60 °C
Nominal tightening torque	9.5 Nm
Tolerance for nominal tightening torque	± 15 %
Product weight	167 g
Pneumatic connection, port 1	Male thread G1/4