

# Proximity Sensor SIEH-M18B-NS-S-L

Part number: 150457

FESTO

Inductive, for large switching distances.

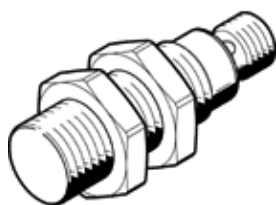

## Data sheet

Feature	Value
Conforms to standard	EN 60947-5-2
Authorization	RCM Mark c UL us - Listed (OL)
CE symbol (see declaration of conformity)	according to EU-EMV guideline
Materials note	Conforms to RoHS
Nominal switching distance	8 mm
Guaranteed switching distance	6.48 mm
Reduction factors	Aluminum = 0.35 Stainless steel, St 18/8 = 0.7 Copper = 0.3 Brass = 0.4 Steel, St 37 = 1.0
Ambient temperature	-25 ... 70 °C
Repetition accuracy	0.4 mm
Switch output	NPN
Switching element function	Normally open contact
Hysteresis	≤ 0.88 mm
Max. switching frequency	1,500 Hz
Max. output current	200 mA
Voltage drop	≤ 2 V
Short circuit strength	Pulsing
Operating voltage range DC	10 ... 30 V
Residual ripple	+/- 20 %
Idle current	≤ 10 mA
Polarity protected	for all electrical connections
Electrical connection	3-pin M12x1 Plug
Size	M18
Mounting type	with lock nut
Tightening torque	20 Nm
Type of installation	flush
Product weight	43 g
Material housing	Brass PBTP Nickel plated
Operating status display	Yellow LED
Ambient temperature with flexible cable installation	-5 ... 70 °C
Protection class	IP67
Surge strength	0.8 kV
PWIS conformity	VDMA24364-B2-L
Degree of contamination	3