

Stepper motor

EMMS-ST-42-S-SEB-G2

Part number: 1370473

★ Core product range

Without gear unit/with brake.

FESTO

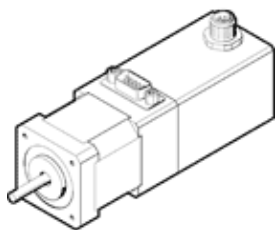

Data sheet

Feature	Value
Ambient temperature	-10 ... 50 °C
Storage temperature	-20 ... 70 °C
Relative air humidity	0 - 85 %
Conforms to standard	IEC 60034
Insulation protection class	B
Thermal class according to EN 60034-1	B
Rating class according to EN 60034-1	S1
Protection class	IP54
Electrical connector system	Plug
Materials note	Conforms to RoHS
Corrosion resistance classification CRC	1 - Low corrosion stress
PWIS conformity	VDMA24364-B2-L
Authorization	RCM Mark c UL us - Recognized (OL)
CE symbol (see declaration of conformity)	according to EU-EMV guideline in accordance with EU RoHS directive
UKCA marking (see declaration of conformity)	To UK instructions for EMC To UK RoHS instructions
Nominal operating voltage DC	48 V
Motor holding torque	0.5 Nm
Max. speed	1,740 1/min
Stepper angle at full step	1.8 deg
Stepper angle tolerance	±5 %
Nominal motor current	1.8 A
Voltage constant, phase	23 mVmin
Winding resistance phase	1.75 Ohm
Winding inductance phase	3.3 mH
Mass moment of inertia of rotor	0.082 kgcm ²
Overall mass moment of inertia at power take-off	0.095 kgcm ²
Product weight	600 g
Permissible axial shaft load	7 N
Permissible radial shaft load	20 N
Rotor position sensor	Incremental encoder
Rotary position encoder interface	RS422 TTL AB-channel + zero index
Rotary position encoder measuring principle	Optical
Brake holding torque	0.4 Nm
Operating voltage DC for brake	24 V
Power consumption, brake	8 W
Mass moment of inertia of brake	0.013 kgcm ²