

semi-rotary drive

DAPS-0060-090-R-F0305-CR

Part number: 552871

FESTO

double-acting, air connection to VDI/VDE 3845 Namur valves, direct flange mounting, stainless steel version.

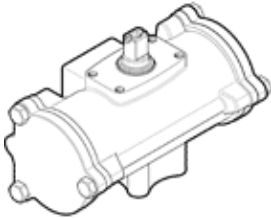

Data sheet

Feature	Value
Size of actuator	0060
Flange hole pattern	F03 F05
Swivel angle	90 deg
Shaft connection depth	12.1 mm
Fitting connection conforms to standard	ISO 5211
Cushioning	No cushioning
Assembly position	Any
Mode of operation	double-acting
Design structure	Yoke kinematics
Position detection	No
Closing direction	right-closing
Valve connection conforms to standard	VDI/VDE 3845 (NAMUR)
Safety Integrity Level (SIL)	Product can be used in SRP/CS up to SIL 2 (high demand) Product can be used in SRP/CS up to SIL 2 low demand
Operating pressure MPa	0.25 ... 0.84 MPa
Operating pressure	2.5 ... 8.4 bar
Nominal operating pressure	0.56 MPa 5.6 bar
CE mark (see declaration of conformity)	to EU directive explosion protection (ATEX)
UKCA marking (see declaration of conformity)	To UK EX instructions
Certificate issuing department	TÜV Nord 212170801
ATEX category Gas	II 2G
ATEX category Dust	II 2D
Explosion ignition protection type Gas	Ex h IIC T6...T3 Gb X
Explosion ignition protection type Dust	Ex h IIIC T85°C...T200°C Db X
Explosion-proof ambient temperature	-20°C ≤ Ta ≤ +60°C
Operating medium	Compressed air in accordance with ISO8573-1:2010 [7:4:4]
Note on operating and pilot medium	Lubricated operation possible (subsequently required for further operation)
Corrosion resistance classification CRC	3 - High corrosion stress
PWIS conformity	VDMA24364-B1/B2-L
Ambient temperature	-20 ... 80 °C
Torque at rated operating pressure and 0° rotation angle	60 Nm
Torque at nominal operating pressure with 50° swivel angle	30 Nm
Torque at nominal operating pressure with 90° swivel angle	45 Nm
Air consumption at 0.6 MPa (6 bar, 87 psi) per cycle 0°-nominal swivel angle-0°	1.96 l
Product weight	1,800 g
Shaft connection	T11
Pneumatic connection	G1/8
Materials note	Conforms to RoHS
Material cover	High alloy steel, non-corrosive

Feature	Value
Material number, cover	1.4408
Material seals	FPM NBR PUR
Material housing	High alloy steel, non-corrosive
Material number for housing	1.4408
Material screws	High alloy steel, non-corrosive
Material shaft	High alloy steel, non-corrosive
Material number for shaft	1.4301