

solenoid valve

NVF3-MOH-5/2-K-1/4-EX

FESTO

Part number: 535987

Classic - do not use for new projects

With NAMUR port pattern to VDE/VDI 3845, without solenoid coil, without socket.

Modern alternatives can be found by entering the first four characters of the type code in the search field.

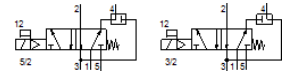
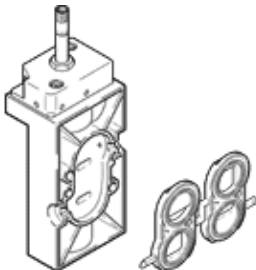

Data sheet

| Feature | Value |
|---|---|
| Valve function | 5/2-way or 3/2-way, single solenoid |
| Type of actuation | electrical |
| Width | 53 mm |
| Standard nominal flow rate | 900 l/min |
| Operating pressure MPa | 0.2 ... 1 MPa |
| Operating pressure | 2 ... 10 bar |
| Design structure | Poppet seat |
| Type of reset | mechanical spring |
| CE mark (see declaration of conformity) | to EU directive explosion protection (ATEX) |
| Explosion protection certification outside the EU | EPL Db (GB) EPL Gb (GB) |
| UKCA marking (see declaration of conformity) | To UK EX instructions |
| ATEX category Gas | II 2G |
| ATEX category Dust | II 2D |
| Explosion ignition protection type Gas | Ex h IIC T6 Gb |
| Explosion ignition protection type Dust | Ex h IIIC T70°C Db |
| Explosion-proof ambient temperature | -5°C ≤ Ta ≤ +40°C |
| Nominal size | 7 mm |
| Exhaust-air function | throttleable |
| Sealing principle | soft |
| Assembly position | Any |
| Conforms to standard | VDI/VDE 3845 (NAMUR) |
| Manual override | detenting Pushing |
| Type of piloting | Piloted |
| Flow direction | non reversible |
| Overlap | Underlap |
| b value | 0.33 |
| C value | 4.2 l/sbar |
| Switching time off | 100 ms |
| Switching time on | 50 ms |
| Operating medium | Compressed air in accordance with ISO8573-1:2010 [7:4:4] |
| Note on operating and pilot medium | Lubricated operation possible (subsequently required for further operation) |
| Corrosion resistance classification CRC | 1 - Low corrosion stress |
| PWIS conformity | VDMA24364-B1/B2-L |
| Medium temperature | -5 ... 40 °C |
| Ambient temperature | -5 ... 40 °C |
| Product weight | 280 g |
| Mounting type | on manifold rail |
| Scavenging orifice connection | Internal |

| Feature | Value |
|------------------------------|--------------------|
| Pilot exhaust port 84 | M5 |
| Pneumatic connection, port 1 | G1/4 |
| Pneumatic connection, port 2 | NAMUR port pattern |
| Pneumatic connection, port 3 | G1/4 |
| Pneumatic connection, port 4 | NAMUR port pattern |
| Pneumatic connection, port 5 | G1/4 |
| Material seals | NBR |
| Material housing | Aluminium die cast |