

# linear/swivel clamp

## CLR-32-20-R-P-A-B-K11-R8

Part number: 535490

FESTO

clamping system with linear and swivel motion 90 degrees to the right.  
standard hole pattern according to ISO 21287. With dust and weld  
spatter protection.

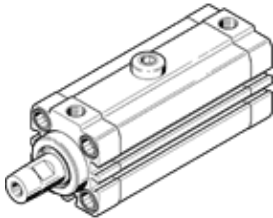

### Data sheet

Feature	Value
Total stroke	38 mm
Piston diameter	32 mm
Piston rod thread	M8
Swivel angle	90 deg +/- 2 deg
Clamping stroke	20 mm
Cushioning	P: Flexible cushioning rings/plates at both ends
Assembly position	Any
Design structure	Piston Piston rod Cylinder barrel
Position detection	For proximity sensor
Swivel direction	Right
Variants	spatter protection Dust protection
Operating pressure	2 ... 10 bar
Mode of operation	double-acting
Operating medium	Compressed air in accordance with ISO8573-1:2010 [7:4:4]
Note on operating and pilot medium	Lubricated operation possible (subsequently required for further operation)
Corrosion resistance classification CRC	2 - Moderate corrosion stress
PWIS conformity	VDMA24364-B2-L
Ambient temperature	-10 ... 80 °C
Effective clamping force at 0.2 MPa (2 bar, 29 psi)	111 N
Effective clamping force at 0.4 MPa (4 bar, 58 psi)	216 N
Effective clamping force at 0.6 MPa (6 bar, 87 psi)	313 N
Max. tightening torque, tensioning finger screw	24 Nm
Theoretical clamping force at 0.6 MPa (6 bar, 87 psi)	362 N
Product weight	785 g
Mounting type	with through hole with internal (female) thread with accessories Optional
Pneumatic connection	G1/8
Material wiper seal	PPS
Material of flange screw	Steel Galvanised
Material cover	Wrought Aluminium alloy coated
Material seals	NBR TPE-U(PU)
Material housing	Wrought Aluminium alloy Smooth anodised
Material piston rod	coated High alloy steel, non-corrosive
Material cylinder barrel	Wrought Aluminium alloy Smooth anodised