

linear/swivel clamp CLR-32-10-L-P-A-B-K11-R8

Part number: 535488

FESTO

clamping system with linear and swivel motion 90 degrees to the left.
standard hole pattern according to ISO 21287. With dust and weld
spatter protection.

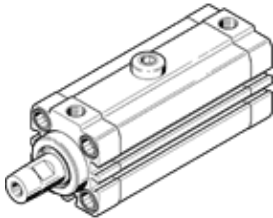

Data sheet

| Feature | Value |
|---|--|
| Total stroke | 28 mm |
| Piston diameter | 32 mm |
| Piston rod thread | M8 |
| Swivel angle | 90 deg +/- 2 deg |
| Clamping stroke | 10 mm |
| Cushioning | P: Flexible cushioning rings/plates at both ends |
| Assembly position | Any |
| Design structure | Piston Piston rod Cylinder barrel |
| Position detection | For proximity sensor |
| Swivel direction | Left |
| Variants | spatter protection Dust protection |
| Operating pressure | 2 ... 10 bar |
| Mode of operation | double-acting |
| Operating medium | Compressed air in accordance with ISO8573-1:2010 [7:4:4] |
| Note on operating and pilot medium | Lubricated operation possible (subsequently required for further operation) |
| Corrosion resistance classification CRC | 2 - Moderate corrosion stress |
| PWIS conformity | VDMA24364-B2-L |
| Ambient temperature | -10 ... 80 °C |
| Effective clamping force at 0.2 MPa (2 bar, 29 psi) | 111 N |
| Effective clamping force at 0.4 MPa (4 bar, 58 psi) | 216 N |
| Effective clamping force at 0.6 MPa (6 bar, 87 psi) | 313 N |
| Max. tightening torque, tensioning finger screw | 24 Nm |
| Theoretical clamping force at 0.6 MPa (6 bar, 87 psi) | 362 N |
| Product weight | 700 g |
| Mounting type | with through hole with internal (female) thread with accessories Optional |
| Pneumatic connection | G1/8 |
| Material wiper seal | PPS |
| Material of flange screw | Steel Galvanised |
| Material cover | Wrought Aluminium alloy coated |
| Material seals | NBR TPE-U(PU) |
| Material housing | Wrought Aluminium alloy Smooth anodised |
| Material piston rod | coated High alloy steel, non-corrosive |
| Material cylinder barrel | Wrought Aluminium alloy Smooth anodised |