

# linear/swivel clamp CLR-12-20-L-P-A

Part number: 535434

FESTO

Clamping system with linear and swivel motion, 90° to the left

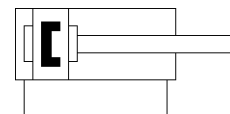
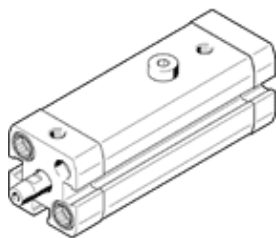

## Data sheet

| Feature   | Value  |
|---|--|
| Total stroke  | 29 mm  |
| Piston diameter                                       | 12 mm  |
| Piston rod thread                                     | M3   |
| Swivel angle  | 90 deg +/- 4 deg   |
| Clamping stroke                                       | 20 mm  |
| Cushioning  | P: Flexible cushioning rings/plates at both ends                                   |
| Assembly position                                     | Any  |
| Design structure                                      | Piston<br>Piston rod<br>Cylinder barrel  |
| Position detection                                    | For proximity sensor   |
| Swivel direction                                      | Left   |
| Operating pressure                                    | 2 ... 10 bar   |
| Mode of operation                                     | double-acting  |
| Operating medium                                      | Compressed air in accordance with ISO8573-1:2010 [7:4:4]                           |
| Note on operating and pilot medium                    | Lubricated operation possible (subsequently required for further operation)        |
| Corrosion resistance classification CRC               | 2 - Moderate corrosion stress  |
| PWIS conformity                                       | VDMA24364-B2-L   |
| Ambient temperature                                   | -10 ... 80 °C  |
| Effective clamping force at 0.2 MPa (2 bar, 29 psi)   | 12 N   |
| Effective clamping force at 0.4 MPa (4 bar, 58 psi)   | 23 N   |
| Effective clamping force at 0.6 MPa (6 bar, 87 psi)   | 34 N   |
| Max. tightening torque, tensioning finger screw       | 1.2 Nm   |
| Theoretical clamping force at 0.6 MPa (6 bar, 87 psi) | 51 N   |
| Product weight  | 160 g  |
| Mounting type   | with through hole<br>with internal (female) thread<br>with accessories<br>Optional |
| Pneumatic connection                                  | M5   |
| Material of flange screw                              | Steel<br>Galvanised  |
| Material cover  | Wrought Aluminium alloy<br>coated  |
| Material seals  | NBR<br>TPE-U(PU)   |
| Material housing                                      | Wrought Aluminium alloy<br>Smooth anodised   |
| Material piston rod                                   | High alloy steel, non-corrosive  |
| Material cylinder barrel                              | Wrought Aluminium alloy<br>Smooth anodised   |