

connecting cable VMPA-KMS1-8-5

Part number: 533196

FESTO

For multi-pin plug connection to valve terminal MPA-S.

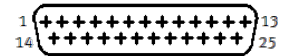
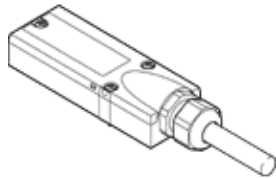

Data sheet

Feature	Value
Based on the standard	DIN 41652
Cable identification	with accessories
Connection frequency	50
Product weight	510 g
Electrical connection 1, function	Field device side
Electrical connection 1, design	Angular
Electrical connection 1, connection type	Plug socket
Electrical connection 1, cable outlet	Angled
Electrical connection 1, connection technology	Sub-D
Electrical connection 1, number of pins/wires	25
Electrical connection 1, occupied pins/wires	9
Electrical connection 1, type of mounting	3x M3 screws
Electrical connection 2, function	Controller side
Electrical connection 2, connection type	Cable
Electrical connection 2, connection technology	Open end
Electrical connection 2, number of pins/wires	10
Electrical connection 2, occupied pins/wires	9
Operating voltage range DC	0 ... 30 V
Nominal operating voltage DC	24 V
Permissible current load	3 A
Surge strength	1 kV
Cable length	5 m
Cable attribute	Standard
Test conditions of cable	Test conditions on request
Bending radius, fixed cable installation	28.6 mm
Bending radius, flexible cable installation	71.5 mm
Cable gland connection	M20x1,5
Cable diameter	7.15 mm
Cable diameter tolerance	± 0,3 mm
Cable structure	10x0,34
Nominal conductor cross-section	0.34 mm ²
Wire ends	Cut off bluntly
Protection class	IP65 to IEC 60529
Note on degree of protection	in assembled condition
Ambient temperature	-25 ... 80 °C
Ambient temperature with flexible cable installation	-5 ... 70 °C
CE mark (see declaration of conformity)	in accordance with EU RoHS directive
UKCA marking (see declaration of conformity)	To UK RoHS instructions
PWIS conformity	VDMA24364-B2-L
Materials note	Conforms to RoHS
Degree of contamination	3
Corrosion resistance classification CRC	2 - Moderate corrosion stress
Material cable sheath	PVC

Feature	Value
Cable sheath colour	Grey
Material housing	PA
Housing colour	Grey
Material of union nut	PA
Material seals	CR NBR
Material electrical contact	Gold-plated copper alloy