

connecting cable

VMPA-KMS1-8-2.5

Part number: 533195

FESTO

For multi-pin plug connection to valve terminal MPA-S.

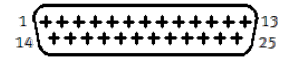
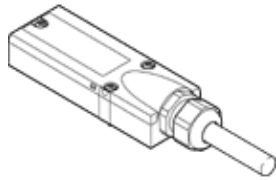

Data sheet

| Feature | Value |
|--|--------------------------------------|
| Based on the standard | DIN 41652 |
| Cable identification | with accessories |
| Connection frequency | 50 |
| Product weight | 287 g |
| Electrical connection 1, function | Field device side |
| Electrical connection 1, design | Angular |
| Electrical connection 1, connection type | Plug socket |
| Electrical connection 1, cable outlet | Angled |
| Electrical connection 1, connection technology | Sub-D |
| Electrical connection 1, number of pins/wires | 25 |
| Electrical connection 1, occupied pins/wires | 9 |
| Electrical connection 1, type of mounting | 3x M3 screws |
| Electrical connection 2, function | Controller side |
| Electrical connection 2, connection type | Cable |
| Electrical connection 2, connection technology | Open end |
| Electrical connection 2, number of pins/wires | 10 |
| Electrical connection 2, occupied pins/wires | 9 |
| Operating voltage range DC | 0 ... 30 V |
| Nominal operating voltage DC | 24 V |
| Permissible current load | 3 A |
| Surge strength | 1 kV |
| Cable length | 2.5 m |
| Cable attribute | Standard |
| Test conditions of cable | Test conditions on request |
| Bending radius, fixed cable installation | 28.4 mm |
| Bending radius, flexible cable installation | 71.5 mm |
| Cable gland connection | M20x1,5 |
| Cable diameter | 7.15 mm |
| Cable diameter tolerance | ± 0,3 mm |
| Cable structure | 10x0,34 |
| Nominal conductor cross-section | 0.34 mm ² |
| Wire ends | Cut off bluntly |
| Protection class | IP65 to IEC 60529 |
| Note on degree of protection | in assembled condition |
| Ambient temperature | -25 ... 80 °C |
| Ambient temperature with flexible cable installation | -5 ... 70 °C |
| CE mark (see declaration of conformity) | in accordance with EU RoHS directive |
| UKCA marking (see declaration of conformity) | To UK RoHS instructions |
| PWIS conformity | VDMA24364-B2-L |
| Materials note | Conforms to RoHS |
| Degree of contamination | 3 |
| Corrosion resistance classification CRC | 2 - Moderate corrosion stress |
| Material cable sheath | PVC |

| Feature | Value |
|-----------------------------|--------------------------|
| Cable sheath colour | Grey |
| Material housing | PA |
| Housing colour | Grey |
| Material of union nut | PA |
| Material seals | CR NBR |
| Material electrical contact | Gold-plated copper alloy |