

ball valve

VZBM-11/2-RP-25-D-2-F0305-B2B3

Part number: 4405652

FESTO

Brass, 2/2-way, nominal width 11/2", top flange F0305, PN25, thread EN 10226-1.

Festo is only a retailer of this product, not the manufacturer.

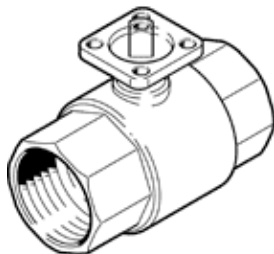

Data sheet

Feature	Value
Design structure	2-way ball valve
Type of actuation	mechanical
Sealing principle	soft
Assembly position	Any
Mounting type	Line installation
Process valve connection	Rp1 1/2
Switching position indicator	Slot direction = flow direction
Flange hole pattern	F03 F05
Inside diameter	40 mm
Nominal diameter DN	40
Valve function	2/2
Flow direction	reversible
Nominal pressure of process valve	25
Breakaway torque at differential pressure, nominal pressure, process valve PN	9.5 Nm
Based on the standard	EN 10226-1 ISO 5211
Medium	Compressed air in accordance with ISO8573-1:2010 [-:~:] Inert gases Water (no water vapour) Neutral fluids
Medium temperature	-15 ... 90 °C
Flow rate Kv	156 m ³ /h
Materials note	Conforms to RoHS
PWIS conformity	VDMA24364 zone III
Material housing	Brass Nickel plated
Material number for housing	CW617N
Material seals	FPM HNBR PTFE
Material ball	Brass Chromed-plated
Material number for ball	CW617N
Material shaft	Brass
Material number for shaft	CW617N
Product weight	1,135 g
CE mark (see declaration of conformity)	to EU directive pressure devices
Corrosion resistance classification CRC	1 - Low corrosion stress