

Semi-rotary drive DRQ-50-90-PPV-A

Part number: 30584
Product to be discontinued

FESTO

For proximity sensing, with adjustable end-position cushioning and backlash-compensating gearing.

Type to be discontinued. Available until 2017. See Support Portal for alternative products.

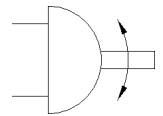
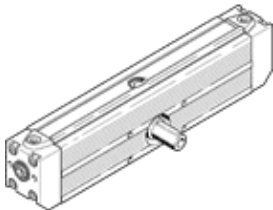

Data sheet

Feature	Value
Size	50
Cushioning angle	84 deg
Swivel angle	90 deg
End-position tolerance	6 deg
Cushioning	PPV: Pneumatic cushioning adjustable at both ends
Assembly position	Any
Design structure	Rack and pinion
Position detection	For proximity sensor
Operating pressure	2.5 ... 10 bar
Max. swivel frequency at 6 bar	2.6 Hz
Mode of operation	double-acting
Operating medium	Compressed air in accordance with ISO8573-1:2010 [7:-:-]
Ambient temperature	-10 ... 60 °C
Theoretical torque at 6 bar	19 Nm
Permissible mass moment of inertia	0.016 kgm ²
Product weight	5,030 g
Mounting type	with internal (female) thread
Pneumatic connection	G1/4
Materials information for drive shaft	Case-hardened steel
Materials information for seals	TPE-U(PU)