

sub-base NAUE-1/4-NPT-1-ISO

Part number: 30427

FESTO

With port pattern in accordance with ISO 5599/I and pre-assembled integrated electrical connection in accordance with ISO 5599/II. Connections underneath.

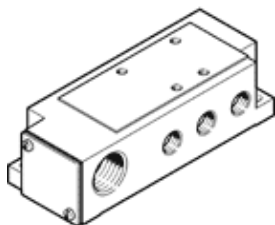

Data sheet

Feature	Value
Operating pressure	0 ... 16 bar
Authorisation	UL - Recognized (OL)
Operating medium	Compressed air in accordance with ISO8573-1:2010 [7:-:-]
Corrosion resistance classification CRC	2 - Moderate corrosion stress
PWIS conformity	VDMA24364-B1/B2-L
Medium temperature	-10 ... 60 °C
Protection class	IP65
Ambient temperature	-10 ... 60 °C
Mounting type	with through hole
Pilot air port 12	1/8 NPTF
Pilot air port 14	1/8 NPTF
Pneumatic connection, port 1	1/4 NPTF
Pneumatic connection, port 2	1/4 NPTF
Pneumatic connection, port 3	1/4 NPTF
Pneumatic connection, port 4	1/4 NPTF
Pneumatic connection, port 5	1/4 NPTF