

Semi-rotary drive DRQ-100-360-PPVJ-A

Part number: 19394
Product to be discontinued

FESTO

For proximity sensing, with adjustable end-position cushioning and backlash-compensating gearing.

Type to be discontinued. Available until 2017. See Support Portal for alternative products.

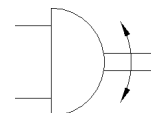
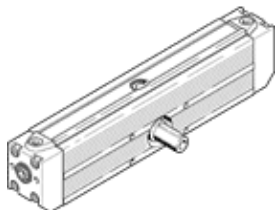

Data sheet

Feature	Value
Size	100
Cushioning angle	52 deg
Setting range of swivel angle on both sides	-8 /+ 8 deg
Swivel angle	360 deg
Cushioning	PPVJ: Pneumatic cushioning, adjustable
Assembly position	Any
Design structure	Rack and pinion
Position detection	For proximity sensor
Operating pressure	2.5 ... 10 bar
Max. swivel frequency at 6 bar	0.4 Hz
Mode of operation	double-acting
Operating medium	Compressed air in accordance with ISO8573-1:2010 [7:-:-]
Ambient temperature	-10 ... 60 °C
Theoretical torque at 6 bar	150 Nm
Permissible mass moment of inertia	0.2 kgm ²
Product weight	40,600 g
Mounting type	with internal (female) thread
Pneumatic connection	G1/2
Materials information for drive shaft	Case-hardened steel
Materials information for seals	TPE-U(PU)