

# spindle axis DGE-63- -SP

Part number: 193748  
Product to be discontinued

FESTO

Electromechanical linear axis with spindle

Type to be discontinued. Available until 2021. See Support Portal for alternative products.

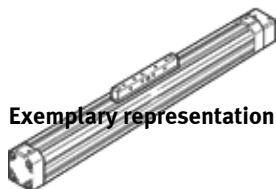

Exemplary representation

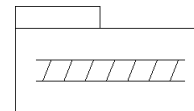

## Data sheet

Overall data sheet – Individual values depend upon your configuration.

Feature	Value
Size	63
Stroke reserve	30 mm
Spindle diameter	32 mm
Spindle pitch	30 mm/U
Guide	Recirculating ball bearing guide Heavy-duty guide
Design structure	Electromechanical linear axis With spindle
Motor type	Stepper motor Servomotor
Max. acceleration	6 m/s <sup>2</sup>
Max. speed	1.2 m/s
Repetition accuracy	±0,02 mm
Ambient temperature	0 ... 40 °C
Max. drive torque	8.5 Nm
Max. radial force at drive shaft	800 N
Max. feed force F <sub>x</sub>	1,600 N
No-load driving torque	1.15 Nm
Mass moment of inertia J <sub>H</sub> per metre of stroke	6.67 kgcm <sup>2</sup>
Mass moment of inertia J <sub>L</sub> per kg of working load	0.228 kgcm <sup>2</sup>
Feed constant	30 mm/U
Material of end caps	Wrought Aluminium alloy Anodised
Material of moment compensator	Wrought Aluminium alloy Anodised
Material of profile	Wrought Aluminium alloy Anodised
Material cover tape	High alloy steel, non-corrosive
Material drive cover	Wrought Aluminium alloy Anodised
Material guide slide	Wrought Aluminium alloy Anodised
Material guide rail	Roller bearing steel corrotec coated
Material spindle nut	Roller bearing steel
Material spindle	Roller bearing steel