

# guided drive DFP-32-250-PPV-A

Part number: 186747  
Product to be discontinued

FESTO

Protected against torsion, for proximity sensing.  
Type to be discontinued. Available until 2018. See Support Portal for alternative products.

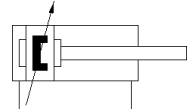
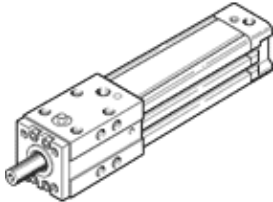

## Data sheet

Feature	Value
Stroke	250 mm
Piston diameter	32 mm
Cushioning	PPV: Pneumatic cushioning adjustable at both ends
Assembly position	Any
Guide	Recirculating ball bearing guide
Design structure	Guide
Position detection	For proximity sensor
Operating pressure	0.5 ... 10 bar
Max. speed	1.5 m/s
Mode of operation	double-acting
Operating medium	Compressed air in accordance with ISO8573-1:2010 [7:4:4]
Note on operating and pilot medium	Lubricated operation possible (subsequently required for further operation)
Corrosion resistance classification CRC	0 - No corrosion stress
Ambient temperature	-10 ... 60 °C
Cushioning length	20 mm
Theoretical force at 6 bar, return stroke	364 N
Theoretical force at 6 bar, advance stroke	483 N
Moving mass	678 g
Product weight	1,914 g
Pneumatic connection	G1/8
Materials note	Free of copper and PTFE
Material cover	Wrought Aluminium alloy
Material seals	NBR
Material housing	Wrought Aluminium alloy
Material piston rod	Heat-treatment steel