

guided drive DFP-32-160-PPV-A

Part number: 186745
Product to be discontinued

FESTO

Protected against torsion, for proximity sensing.
Type to be discontinued. Available until 2018. See Support Portal for alternative products.

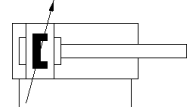
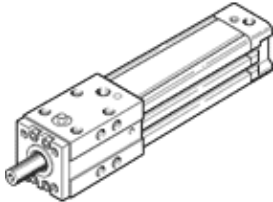

Data sheet

| Feature | Value |
|--------------------------------------------|-----------------------------------------------------------------------------|
| Stroke | 160 mm |
| Piston diameter | 32 mm |
| Cushioning | PPV: Pneumatic cushioning adjustable at both ends |
| Assembly position | Any |
| Guide | Recirculating ball bearing guide |
| Design structure | Guide |
| Position detection | For proximity sensor |
| Operating pressure | 0.5 ... 10 bar |
| Max. speed | 1.5 m/s |
| Mode of operation | double-acting |
| Operating medium | Compressed air in accordance with ISO8573-1:2010 [7:4:4] |
| Note on operating and pilot medium | Lubricated operation possible (subsequently required for further operation) |
| Corrosion resistance classification CRC | 0 - No corrosion stress |
| Ambient temperature | -10 ... 60 °C |
| Cushioning length | 20 mm |
| Theoretical force at 6 bar, return stroke | 364 N |
| Theoretical force at 6 bar, advance stroke | 483 N |
| Moving mass | 535 g |
| Product weight | 1,590 g |
| Pneumatic connection | G1/8 |
| Materials note | Free of copper and PTFE |
| Material cover | Wrought Aluminium alloy |
| Material seals | NBR |
| Material housing | Wrought Aluminium alloy |
| Material piston rod | Heat-treatment steel |