

# semi-rotary drive DRVS-40-270-P

Part number: 1845724

FESTO

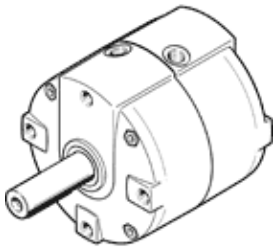

## Data sheet

| Feature  | Value   |
|--|---|
| Size   | 40  |
| Cushioning angle                                 | 0.5 deg   |
| Swivel angle                                     | 0 ... 270 deg   |
| Cushioning                                       | P: Flexible cushioning rings/plates at both ends                            |
| Assembly position                                | Any   |
| Mode of operation                                | double-acting   |
| Design structure                                 | Rotary vane   |
| Position detection                               | For proximity sensor  |
| Variants   | Spigot shaft  |
| Operating pressure MPa                           | 0.2 ... 0.8 MPa   |
| Operating pressure                               | 2 ... 8 bar   |
| Max. swivel frequency at 0.6 MPa (6 bar, 87 psi) | 2 Hz  |
| Operating medium                                 | Compressed air in accordance with ISO8573-1:2010 [7:4:4]                    |
| Note on operating and pilot medium               | Lubricated operation possible (subsequently required for further operation) |
| Corrosion resistance classification CRC          | 1 - Low corrosion stress  |
| PWIS conformity                                  | VDMA24364-B2-L  |
| RSBP classification to CD-0033                   | F1a   |
| Cleanroom class                                  | ISO class 6   |
| Ambient temperature                              | 0 ... 60 °C   |
| Max. axial force                                 | 120 N   |
| Max. radial force                                | 350 N   |
| Theoretical torque at 0.6 MPa (6 bar, 87 psi)    | 20 Nm   |
| Permissible mass moment of inertia               | 0.035 kgm <sup>2</sup>  |
| Product weight                                   | 1,470 g   |
| Mounting type                                    | with internal (female) thread   |
| Pneumatic connection                             | G1/8  |
| Materials note                                   | Conforms to RoHS  |
| Material of drive shaft                          | Steel, nickel-plated  |
| Material seals                                   | TPE-U(PU)   |
| Material housing                                 | Die-cast aluminium, painted   |