

semi-rotary drive DRVS-40-180-P

Part number: 1845723

★ Core product range

FESTO

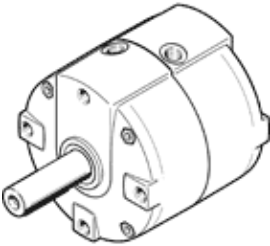

Data sheet

Feature	Value
Size	40
Cushioning angle	0.5 deg
Swivel angle	0 ... 180 deg
Cushioning	P: Flexible cushioning rings/plates at both ends
Assembly position	Any
Mode of operation	double-acting
Design structure	Rotary vane
Position detection	For proximity sensor
Variants	Spigot shaft
Operating pressure MPa	0.2 ... 0.8 MPa
Operating pressure	2 ... 8 bar
Max. swivel frequency at 0.6 MPa (6 bar, 87 psi)	3 Hz
Operating medium	Compressed air in accordance with ISO8573-1:2010 [7:4:4]
Note on operating and pilot medium	Lubricated operation possible (subsequently required for further operation)
Corrosion resistance classification CRC	1 - Low corrosion stress
PWIS conformity	VDMA24364-B2-L
RSBP classification to CD-0033	F1a
Cleanroom class	ISO class 6
Ambient temperature	0 ... 60 °C
Max. axial force	120 N
Max. radial force	350 N
Theoretical torque at 0.6 MPa (6 bar, 87 psi)	20 Nm
Permissible mass moment of inertia	0.035 kgm ²
Product weight	1,500 g
Mounting type	with internal (female) thread
Pneumatic connection	G1/8
Materials note	Conforms to RoHS
Material of drive shaft	Steel, nickel-plated
Material seals	TPE-U(PU)
Material housing	Die-cast aluminium, painted